

PARK MANSIONS, KNIGHTSBRIDGE, LONDON
£1,675 PW



MAYFAIR SQUARE

1 Mayfair Place, London W1J 8AJ, United Kingdom

+44 (0)207 184 9888 | info@mayfairsquare.co.uk | www.mayfairsquare.co.uk

PARK MANSIONS, KNIGHTSBRIDGE, LONDON

£1,675 PW

PROPERTY DESCRIPTION

This wonderful two-bedroom apartment, with both boasting en-suite bathrooms, is situated on the fourth floor of a prestigious building in the highly sought-after area of Knightsbridge, opposite the highly-exclusive One Hyde Park.

As well as featuring two bedrooms, the apartment also comprises a large open-plan reception room containing living and dining areas, plus a fabulous kitchen area which is comprehensively equipped with a large fridge, separate freezer, washing machine, separate tumble dryer, dishwasher, Smeg oven, backup oven and microwave.

Shopping and Eating Out

Knightsbridge is one of the capital's most luxurious shopping districts and is home to many flagship establishments including the world-famous Harrods and Harvey Nichols department stores, which are moments away from each other and just a short walk from the apartment. Sloane Street, widely-regarded as one of the world's most exclusive shopping streets offers a retail experience that is both unique and intimate. This is where you can find influential designers showcasing their collections, with names like Tom Ford, Louis Vuitton, Chloe, Dior, Tiffany, Cartier and Chanel, to name but a few.

Some of the finest restaurants featuring renowned Michelin star chefs can also be found in the Knightsbridge area.

Parks & Green Spaces

Nearby Hyde Park is one of London's finest historic landscapes and covers 350 acres (142 hectares). There is something for everyone here, with over 4,000 trees, the Serpentine Lake, a meadow, horse rides and much more.



MAYFAIR SQUARE

1 Mayfair Place, London W1J 8AJ, United Kingdom

+44 (0)207 184 9888 | info@mayfairsquare.co.uk | www.mayfairsquare.co.uk

PARK MANSIONS, KNIGHTSBRIDGE, LONDON
£1,675 PW



MAYFAIR SQUARE

1 Mayfair Place, London W1J 8AJ, United Kingdom

+44 (0)207 184 9888 | info@mayfairsquare.co.uk | www.mayfairsquare.co.uk



MAYFAIR SQUARE

1 Mayfair Place, London W1J 8AJ, United Kingdom

+44 (0)207 184 9888 | info@mayfairsquare.co.uk | www.mayfairsquare.co.uk

Park Mansions, SW1X

Approximate Gross Internal Area = 102 sq m / 1098 sq ft

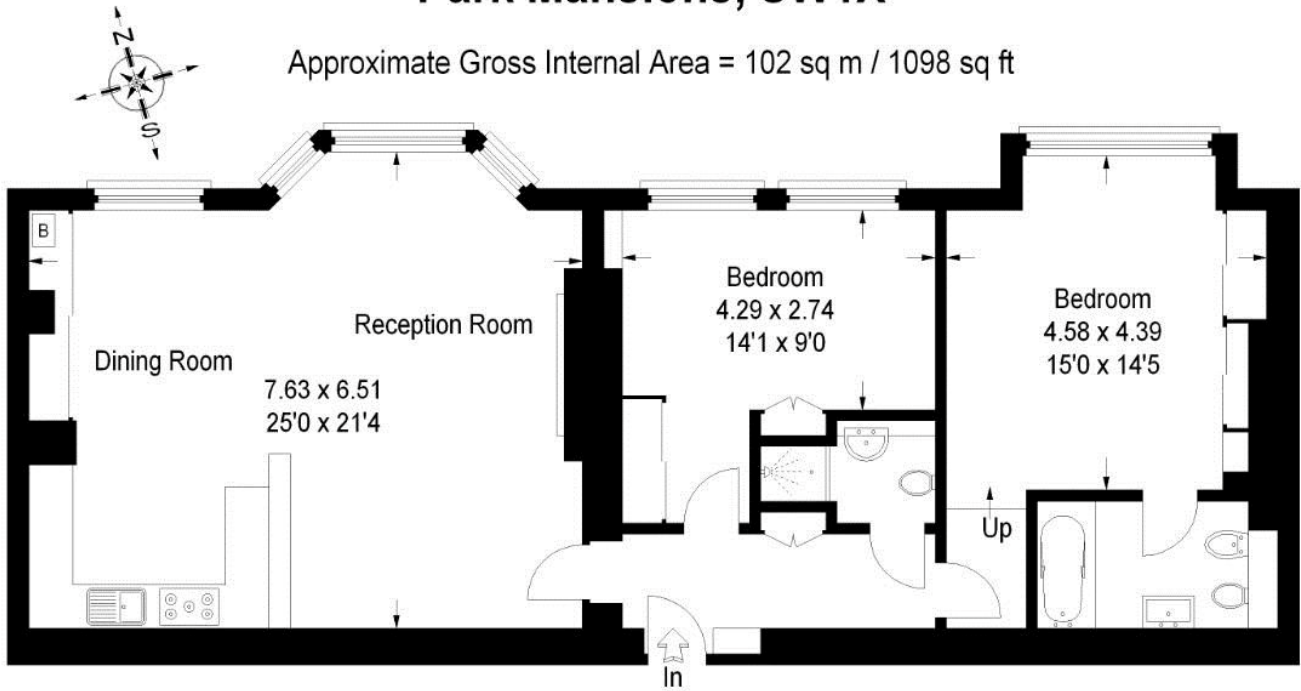

FLOORPLANZ © 2013 0845 6344080 Ref 117588

This plan is for layout guidance only. Not drawn to scale unless stated. Windows & door openings are approximate. Whilst every care is taken in the preparation of this plan, please check all dimensions, shapes & compass bearings before making any decisions reliant upon them.



MAYFAIR SQUARE

1 Mayfair Place, London W1J 8AJ, United Kingdom

+44 (0)207 184 9888 | info@mayfairsquare.co.uk | www.mayfairsquare.co.uk

PARK MANSIONS, KNIGHTSBRIDGE, LONDON

£1,675 PW

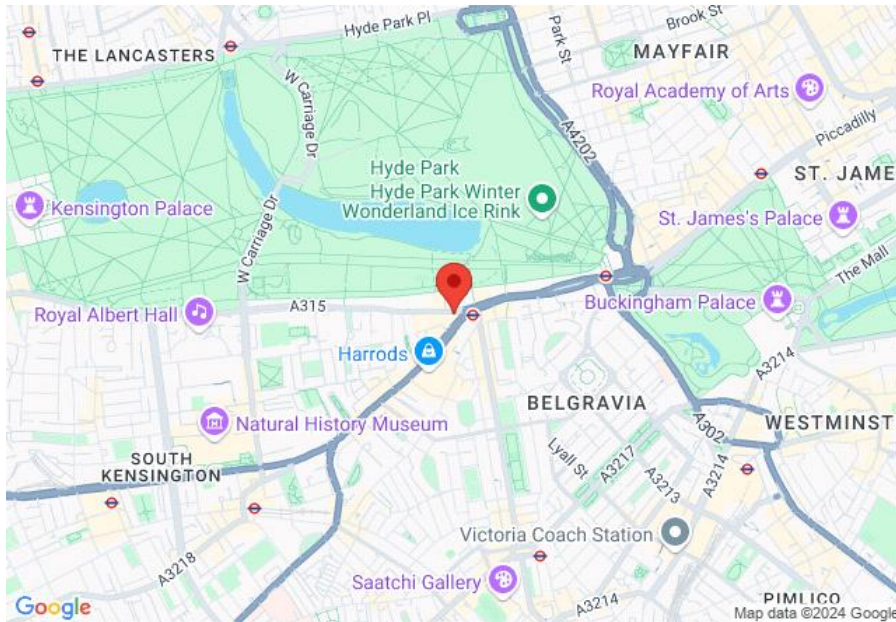

Energy Efficiency Rating		
	Current	Potential
Very energy efficient - lower running costs		
(92-100) A		
(81-91) B		81
(69-80) C		
(55-68) D	67	
(39-54) E		
(21-38) F		
(1-20) G		
Not energy efficient - higher running costs		
England & Wales	EU Directive 2002/91/EC	

The energy efficiency rating is a measure of the overall efficiency of a home. The higher the rating the more energy efficient the home is and the lower the fuel bills will be.



MAYFAIR SQUARE

1 Mayfair Place, London W1J 8AJ, United Kingdom

+44 (0)207 184 9888 | info@mayfairsquare.co.uk | www.mayfairsquare.co.uk

PARK MANSIONS, KNIGHTSBRIDGE, LONDON

£1,675 PW

FOR MORE INFORMATION PLEASE CONTACT US

Important Notice:

Particulars: These particulars are not an offer or contract, nor part of one. You should not rely on statements by Mayfair Square in the particulars or by word of mouth or in writing ("information") as being factually accurate about the property, its condition or its value. Neither Mayfair Square nor any joint agent has any authority to make any representations about the property, and accordingly any information given is entirely without responsibility on the part of the agents, seller(s), lessor(s) or landlord(s).

Any areas, measurements or distances are approximate. The text, photographs and plans are for guidance only and are not necessarily comprehensive. Regulations etc: Any reference to alterations to, or use of, any part of the property does not mean that any necessary planning, building regulations or other consent has been obtained. A buyer or lessee must find out by inspection or in other ways that these matters have been properly dealt with and that all information is correct.



MAYFAIR SQUARE

1 Mayfair Place, London W1J 8AJ, United Kingdom

+44 (0)207 184 9888 | info@mayfairsquare.co.uk | www.mayfairsquare.co.uk
